

THIS DOCUMENT IS THE PROPERTY OF LYTRON, INC. AND REPRESENTS A PROPRIETARY ARTICLE ON WHICH LYTRON, INC. RETAINS ANY AND ALL PATENT AND OTHER RIGHTS, INCLUDING EXCLUSIVE RIGHTS OF USE AND/OR MANUFACTURE AND/OR SALE. POSSESSION OF THIS DOCUMENT DOES NOT CONVEY ANY PERMISSION TO REPRODUCE THE DOCUMENT OR MANUFACTURE THE ARTICLE OR ARTICLES SHOWN THEREIN.

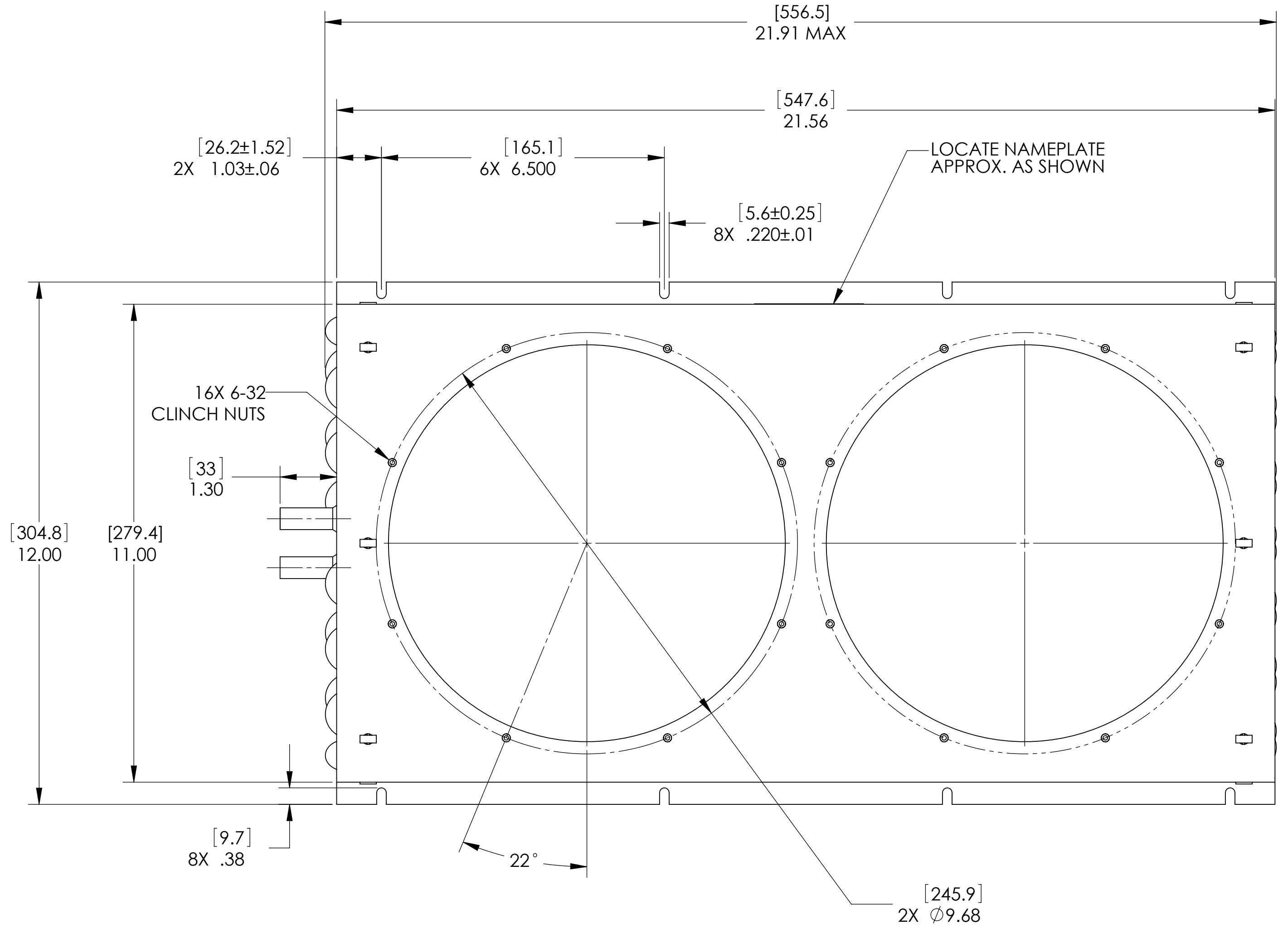
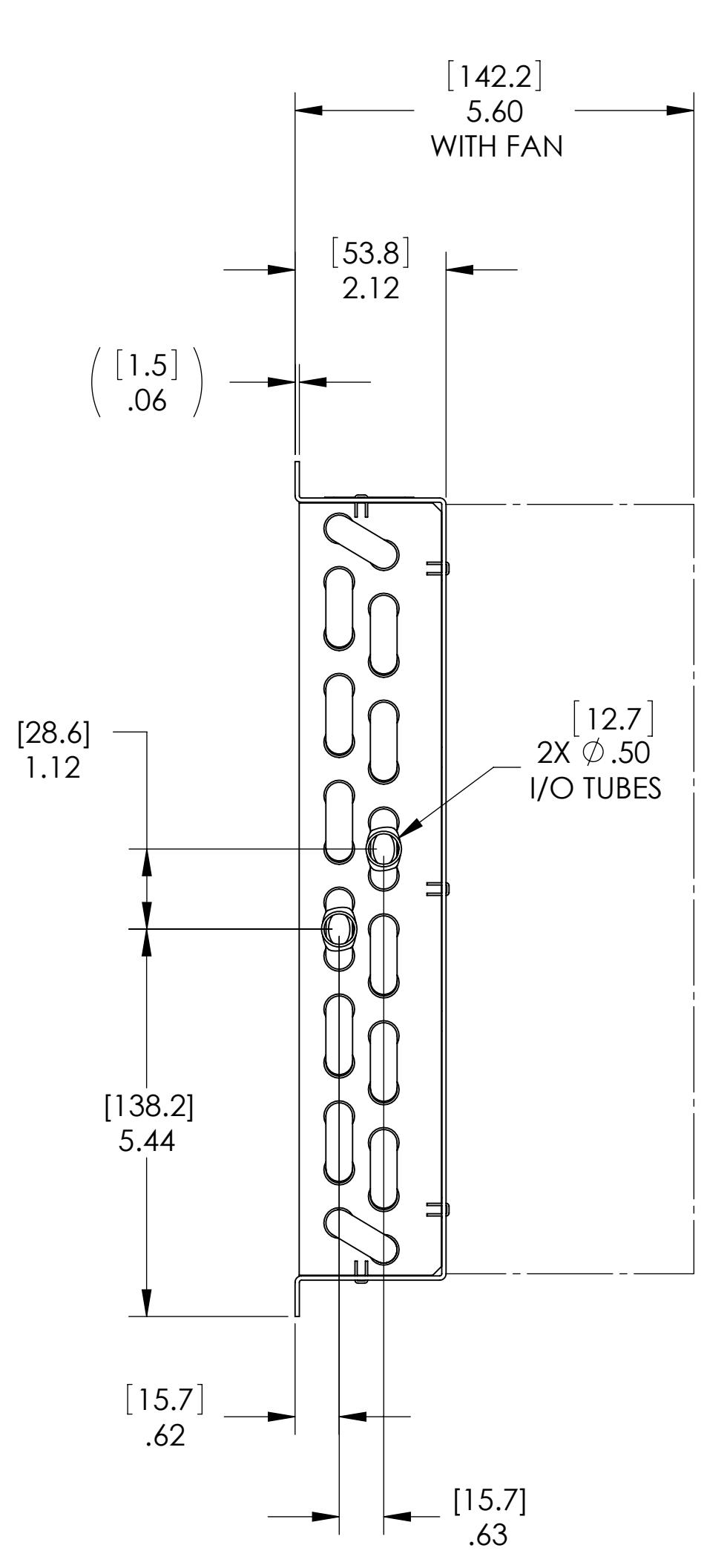

6320G3SB

MATERIAL	
FITTINGS	COPPER
OUTER FIN & TUBE	COPPER
FRAME	ALUMINUM

- NOTES:
1. DIMENSIONS IN [] ARE IN MILLIMETERS.
 2. LEAK TEST- PNEUMATIC PRESSURE TEST AT 150 PSIG.
 3. FINISH WILL BE AS FOLLOWS: SEMI GLOSS BLACK ACRYLIC PAINT.
 4. 1" OF END OF FITTINGS TO BE FREE OF PAINT.

UNLESS OTHERWISE SPECIFIED		DRN	DATE	LYTRON INCORPORATED WOBRURN, MASSACHUSETTS					
ANGULAR DIMENSIONS ± 5° SURFACE ROUGHNESS 125/ (3.2 μ) BREAK EDGES 0.10 (2.5mm) MAX. REMOVE ALL BURRS		CHK'D		DRAWING TITLE HEAT EXCHANGER CORE CODE: L14-2-16-20.06					
TOLERANCE ON DECIMALS		APPV'D							
INCH .X .XX .XXX ±.X ±.10 ±.010 mm ±.XX ±.XX ±.XXX		APPV'D							
DO NOT SCALE THIS DRAWING				MATL	COPPER CORE AND AL SHEET METAL	SIZE	FSCM NO.	DRAWING NO.	REV
THIRD ANGLE PROJECTION DIMENSIONS AND TOLERANCING ARE PER ANSI STD Y14.5				FINISH	NONE	D	11245	S-6320G3SB	L
				SCALE	1/2	WT.		SHEET 1 OF 1	